

PATRICK'S ISLAND 0.25 ACRES, CANAL FRONT PARCEL

Spotts, Cayman Islands

MLS# 419184

CI\$349,000

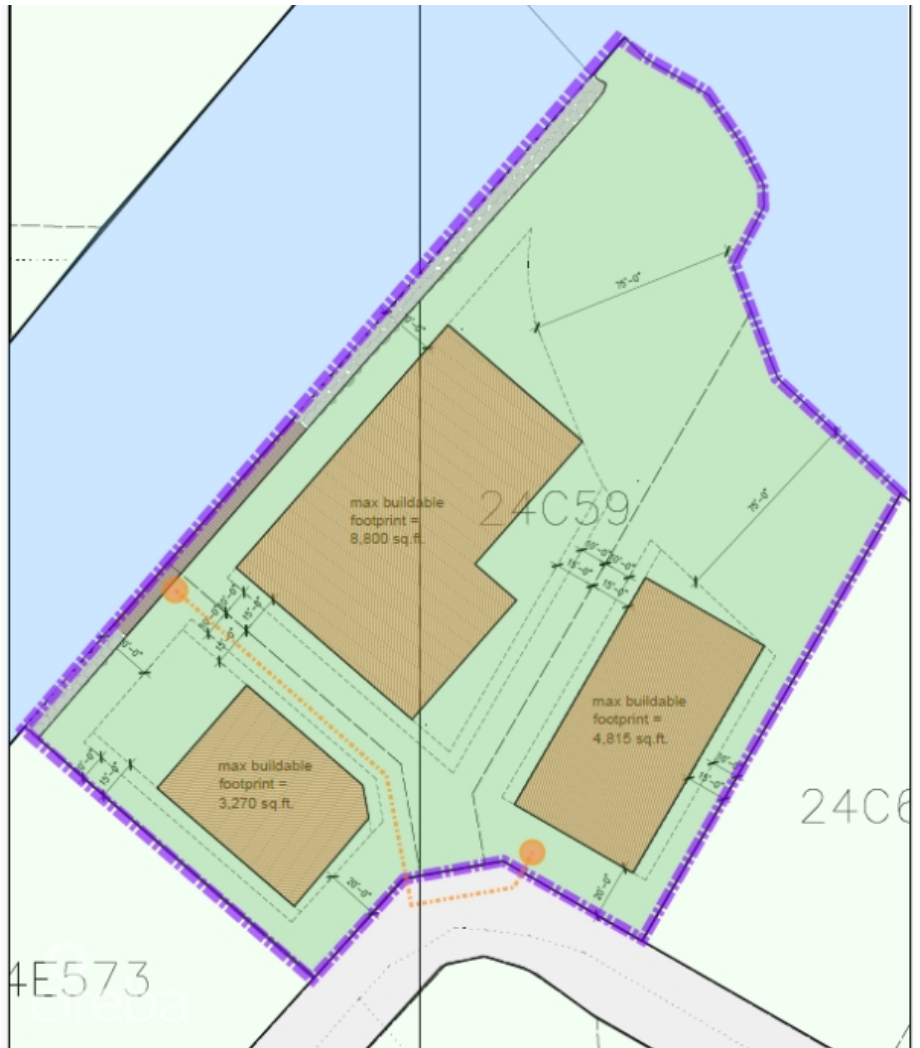

Debi Bergstrom

dbergstrom@edgewater.ky

Situated in the prestigious gated community of Patrick's Island, this canal-front parcel presents an exceptional opportunity to embrace the ultimate boating lifestyle at superb value. With effortless access to the North Sound and peaceful water views, this parcel is a competitively priced home-site for your dream waterfront residence. Subdivision pending, and part agent-owned.

Essential Information

Type	Status	MLS	Listing Type
Land (For Sale)	Current	419184	Low Density Residential

Key Details

Width	Depth	Bed	Bath	Block & Parcel
80.00	140.00	0	0	24C,59LOT1
Acreage				
0.25				
Den	Sq.Ft.			
No	0.00			

Additional Features

Views	Zoning	Sea Frontage	Road Frontage
Water Front	Low Density residential	80	40
Soil			
Other			