



EDGEWATER GROUP
REAL ESTATE & DEVELOPMENT

43 Vibert Bodden Drive, P.O. Box 30132 SMB George Town, Grand Cayman KY1-1201
Cayman Islands, British West Indies.
+1 (345) 946-3343
info@edgewater.ky |

GENEROUS .36 ACRE IN BODDEN TOWN

Bodden Town, Cayman Islands

MLS# 420805

CI\$220,000

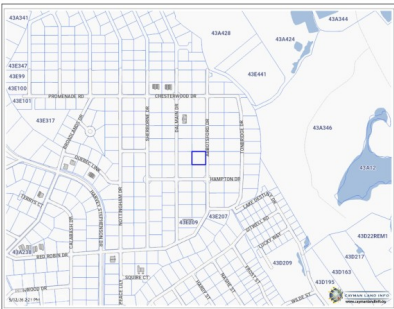



Debi Bergstrom
 dbergstrom@edgewater.ky

Welcome to an exceptional opportunity in the heart of Bodden Town, Cayman's original capital! This generous parcel of land, measuring 15,690 square feet (.3602 Acre), provides the ideal foundation for building the home you have always dreamed of creating. Situated in a quiet neighborhood surrounded by well-kept single-family homes, this property offers a peaceful environment that feels worlds away from the hustle of everyday life. The well-maintained road leading to the lot ensures easy access for daily travel, while city water availability at the site simplifies the building process when you are ready to break ground. The location strikes a wonderful balance between seclusion and convenience. A short drive takes you to Countryside Shopping Centre, where you will find a variety of dining options, retail stores, and essential services to meet your everyday needs. Zoned for low density residential use, this land is perfectly suited for a custom family home designed to your exact specifications. The spacious lot gives you plenty of room to bring your architectural vision to life, whether that includes lush gardens, outdoor entertaining areas, or simply wide open space to enjoy. Whether you are planning to build in the near future or seeking a fantastic investment in one of the island's most historically rich districts, this parcel represents outstanding value and remarkable potential. Call to schedule a viewing and explore everything this property has to offer! Images courtesy of Cayman Land Info.

Essential Information

Type Land (For Sale)	Status New	MLS 420805	Listing Type Low Density Residential
--------------------------------	----------------------	----------------------	--

Key Details

Width 120.00	Depth 128.00	Bed 0	Bath 0	Block & Parcel 43E,223
Acreage 0.36				
Den No	Sq.Ft. 0.00			

Additional Features

Views Garden View	Zoning Low Density residential	Road Frontage 120	Soil Other
-----------------------------	--	-----------------------------	----------------------