

## CAYMAN BRAC LOGHOUSE DRIVE 2.74 ACRES

Cayman Brac East, Cayman Islands

MLS# 419632

**CI\$215,000**

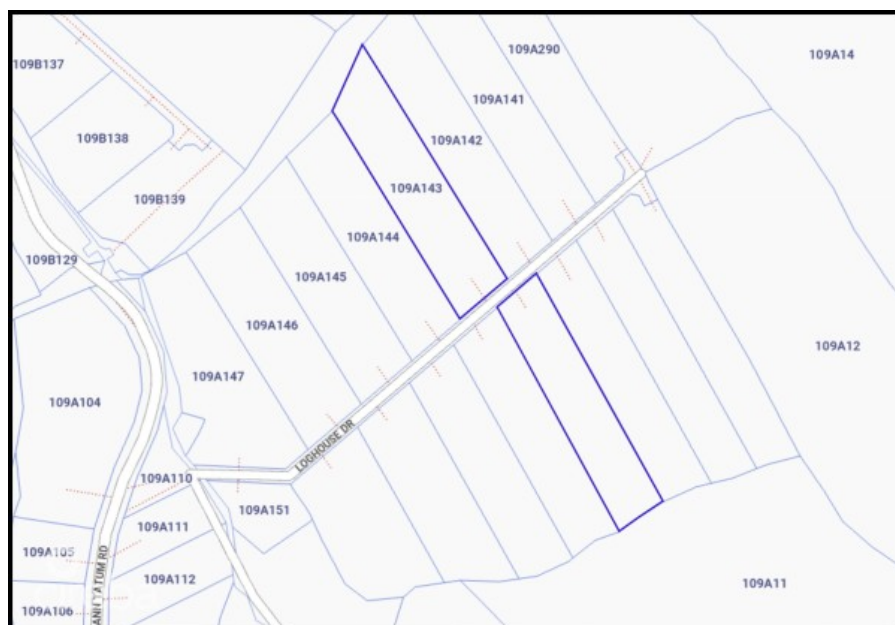
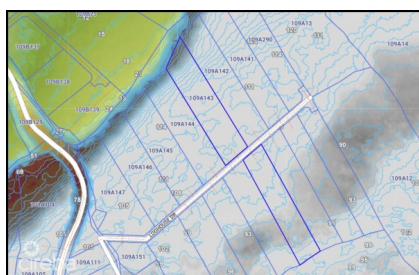

**Debi Bergstrom**

dbergstrom@edgewater.ky

Situated on the coveted Bluff Edge of Cayman Brac's peaceful Eastern side, this rare 2.74-acre parcel offers exceptional privacy and captivating beauty. Perched over 110 feet above sea level, the property commands breathtaking, uninterrupted views of the shimmering Caribbean Sea. Its elevated position captures cooling breezes and showcases some of the island's most spectacular sunsets. With its expansive size, seclusion, and sought-after Bluff Edge location, this is the perfect site for a private estate, luxury villa, or investment in one of the Cayman Islands' most dramatic landscapes.

## Essential Information

Type	Status	MLS	Listing Type
<b>Land (For Sale)</b>	<b>New</b>	<b>419632</b>	<b>Agriculture</b>

## Key Details

Width	Depth	Bed	Bath	Block & Parcel
<b>230.00</b>	<b>1025.00</b>	<b>0</b>	<b>0</b>	<b>109A,143</b>

Acreage  
**2.74**

Den	Sq.Ft.
<b>No</b>	<b>0.00</b>

**Additional Features**

Views	Zoning	Road Frontage	Soil
<b>Water View</b>	<b>Agriculture/Residential</b>	<b>230</b>	<b>Rock</b>